



NV200
OWNER'S MANUAL
ADDENDUM

For your safety, read carefully and keep in this vehicle

NISSAN ANTI-THEFT SYSTEM

(NATS*) KEY (if equipped)

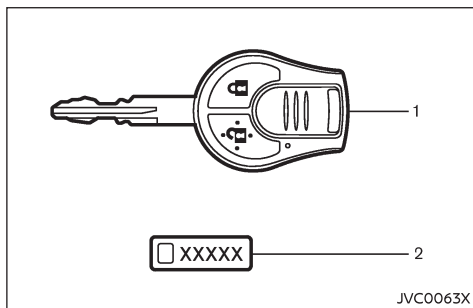

Type D

1. NATS key
 2. Key number plate
- Your vehicle can only be driven with the NATS keys, which are registered to your vehicle's NATS components. As many as 5 NATS keys can be registered and used with one vehicle. The new keys must be registered by a NISSAN dealer prior to use with the NATS of your vehicle. Since the registration process requires erasing all memory in the NATS components when registering new keys, be sure to take all NATS keys that you have to the NISSAN dealer

CAUTION:

Do not allow the NATS key, which contains an electrical transponder, to come into contact with water or salt water. This could affect the system function.

- Immobilizer

REMOTE KEYLESS ENTRY SYSTEM

(if equipped)

The remote keyless entry system can operate all door locks (including the back door) using the remote controller. The remote controller can operate at a distance of approximately 1m (3.3 ft) away from the vehicle. The operating distance depends upon the conditions around the vehicle.

As many as 5 remote controllers can be used with one vehicle. For information about the purchase and use of additional remote controllers, contact a NISSAN dealer.

The remote controller will not function under the following conditions:

- When the distance between the remote controller and vehicle is more than approximately 1m (3.3 ft).
- When the remote controller battery is discharged.
- When the key is in the ignition switch.

CAUTION:

- When locking the doors using the remote controller, be sure not to leave the key in the vehicle.
- Do not allow the remote controller, which contains electrical components, to come into contact with water or salt water. This could affect the system function.
- Do not drop the remote controller.
- Do not strike the remote controller sharply against another object.
- Do not place the remote controller for an extended period in an area where the temperature exceed 60C (140F).

If a remote controller is lost or stolen, NISSAN recommends erasing the ID code of that remote controller from the vehicle. This may prevent the unauthorized use of the remote controller to unlock the vehicle. For information regarding the erasing procedure, contact a NISSAN dealer.

For information regarding the replacement of a battery see "Battery".

USING REMOTE KEYLESS ENTRY SYSTEM

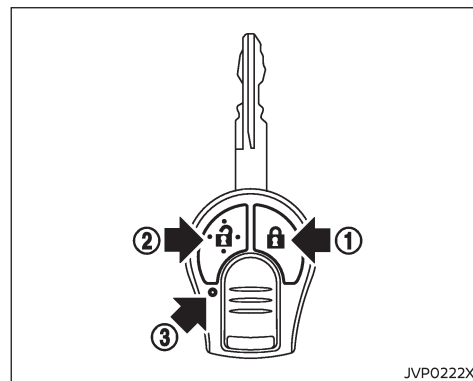

Type C

- ① Lock button
- ② Unlock button
- ③ Battery indicator light

Locking Doors

- Remove the key from the ignition switch.
- Close all doors (including the back door).
- Push the "LOCK" button ① on the remote controller.
- All doors will be locked.
- Operate door handles to confirm that the doors have been securely locked.

CAUTION:

After locking the doors using the remote controller, be sure that the doors have been securely locked by operating the door handles.

Unlocking Doors

1. Push the "UNLOCK"  button on the remote controller.
2. All doors (including the back door) will be unlocked.

All doors will be locked automatically unless one of the following operations is performed within 30 seconds after pushing the "UNLOCK"  button.

- Opening any door.
- Inserting the key into the ignition switch.

During this 30-second time period, if the "UNLOCK"  button is pushed, all doors will be locked automatically after another 30 seconds.

Battery indicator light (if equipped)

The battery indicator light  illuminates when you push any button. If the light does not illuminate, the battery is weak or needs replacement. For information regarding replacement of a battery, see "Remote controller battery".

SECURITY SYSTEM (if equipped)

Your vehicle is equipped with the NISSAN Anti-theft System (NATS)*. (*immobilizer)

NISSAN ANTI-THEFT SYSTEM (NATS)

The NISSAN Anti-Theft System (NATS) will not allow the engine to start without the use of the registered NATS key.

If the engine does not start using the registered NATS key, it may be due to interference caused by:

- Another NATS key.
- Automated toll road device.
- Automated payment device.
- Other devices that transmit similar signals.

Start the engine using the following procedure:

1. Remove any items that may be causing the interference away from the NATS key.
2. Leave the ignition switch in the "ON" position for approximately 5 seconds.
3. Turn the ignition switch to the "OFF" or "LOCK" position, and wait approximately 10 seconds.
4. Repeat steps 2 and 3 again.
5. Start the engine.
6. Repeat the steps above until all possible interferences are eliminated.

If this procedure allows the engine to start, NISSAN recommends placing the registered NATS key separate from other devices to avoid interference.

Security indicator light

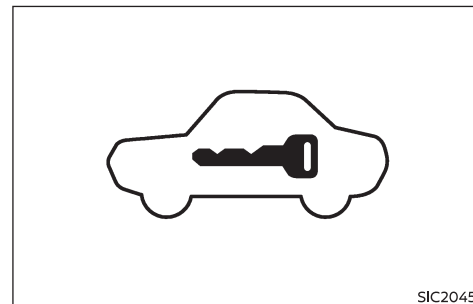

The security indicator light is located on the meter panel. It indicates the status of NATS.

The light operates whenever the ignition switch is in the "LOCK", "OFF", or "ACC" position. The security indicator light indicates that the security systems on the vehicle are operational.

If NATS is malfunctioning, this light will remain on while the ignition switch is in the "ON" position. If the light remains on and/or the engine does not start, contact a NISSAN dealer for NAS service as soon as possible. Be sure to bring all NATS keys that you have when visiting a NISSAN dealer for service.

REMOTE CONTROLLER BATTERY

(if equipped)

Battery Replacement

CAUTION:

- Be careful not to allow children to swallow the battery and removed parts.
- An improperly disposed battery can harm the environment. Always confirm local regulations for battery disposal.
- When changing batteries, do not let dust or oil get on the components.
- There is danger of explosion if lithium battery is incorrectly replaced. Replace only with the same or equivalent type.

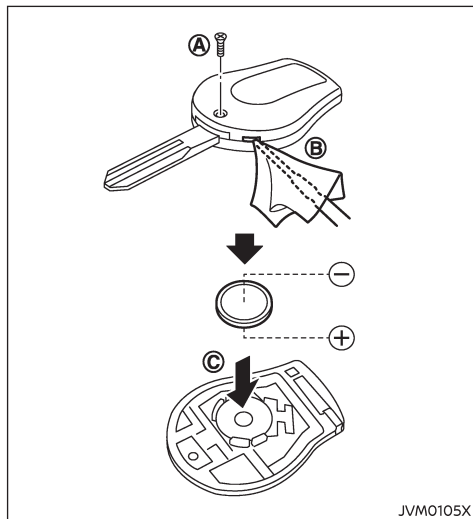

To replace the Battery

1. Remove the screw (A).
2. Insert a small screwdriver into the slit of the corner (B) and twist it to separate the upper part from the lower part. Use a cloth to protect the casing.
3. Replace the battery with a new one
 - Recommended battery: CR1620 or equivalent
 - Do not touch the internal circuit and electric terminals as doing so could cause a malfunction.
 - Make sure that the + side faces the bottom of the case (C).
4. Close the lid and install the screw securely.
5. Operate the buttons to check its operation. See a NISSAN dealer if you need assistance for replacement.

AIR BAG WARNING LABELS

Air bag warning labels (if equipped):



"NEVER use a rearward facing child restraint on a seat protected by an ACTIVE AIRBAG in front of it, DEATH or SERIOUS INJURY to the CHILD can occur."

When installing a child restraint system in your vehicle, always follow the child restraint system manufacturer's instructions for installation.

For additional information, see "CHILD RESTRAINTS" (P.1-15).

Be sure to read "Air bag warning labels" in the "1. Safety - seats, seat belts and supplemental restraint system" section.

© 2022 NISSAN MOTOR CO., LTD.

NISSAN

www.nissan.com.my

Printing:
Publication No:
Printed in Malaysia

M20-A